

## Operating Instructions

### Take out/Put in food bowl

- Press and hold the unlock button for 2 seconds.
- Press and hold the open/close button for 1 second.
- After taking out the food bowl to fill it with food or cleaning it, put it back again.
- Press and hold the open/close button again for 1 second.

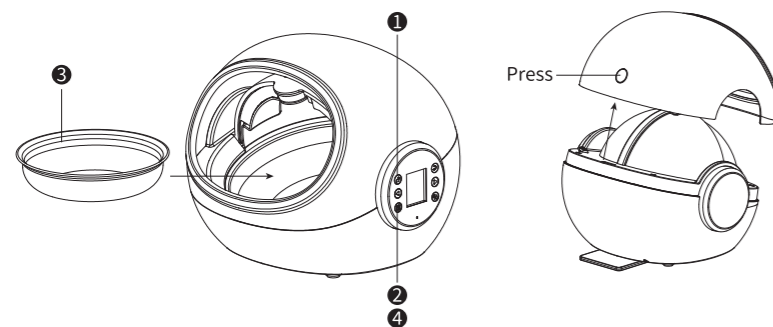

- In order not to affect the normal operation of the feeder, do not add the food beyond the mouth of the bowl.

### Take off the cover

Press the upper cover unlock button, wait until the upper cover pops open, and then separate it from the feeder body.

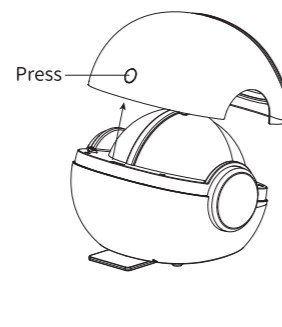

## Operating Instructions

### Cover installation

Align the cover with the feeder, press down until you hear the cover click into place.

- Please be sure to turn off the power while taking off cover and install cover.

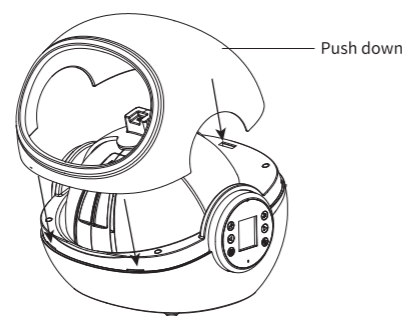

## Cleaning & Maintenance

- Make sure to turn off the power and remove the battery while cleaning & maintenance.

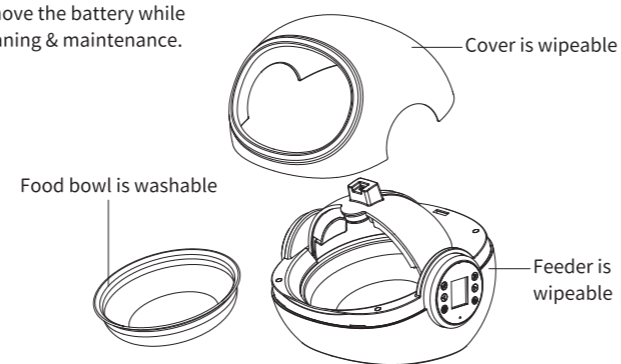

## Suggested Training Mode

If your pet is hesitant or scared of the feeder, we suggest you open the door and unpower the feeder to allow the pet to get comfortable during the feeding process. After a few meals you can power the feeder back on to enable "only allowed pets to eat". Please note this process will allow other pets to eat while training is in process.

## Troubleshooting

<b>Button is not working</b>	Make sure the button is unlocked. Make sure the power cable is connected properly and the power switch turns on.
<b>Unable to open door by RFID tag</b>	Make sure whether it is over the sensing range. Make sure whether the tag has been written successfully. Make sure there is no large area of metal around the feeder.
<b>Unable to open and close the door manually</b>	Make sure there are no objects blocking the revolving door. Restart the feeder.

## NOTES

- Please use the power adapter that comes with the machine.
- It is FORBIDDEN to place the whole feeder into dishwasher or disinfection cabinet.
- It is FORBIDDEN to use microwave ovens to heat the bowl.
- It is FORBIDDEN to use steel balls to clean the bowl.
- The water content should not exceed half a bowl while adding wet food.
- Please do not drop or hit the bowl. If the food bowl is cracked or damaged due to falling or impact, please stop using it.



## Warranty

The Pet Feeder includes a 1-Year Warranty valid in the USA from the date of purchase, provided you have proof of the purchase date. This warranty covers faults due to defective materials, components, or manufacturing. It does not cover defects arising from normal wear and tear, misuse, neglect, or intentional damage.

Follow us on Facebook <https://www.facebook.com/FurBabyFeeder>  
Email: [support@furbabyfeeder.com](mailto:support@furbabyfeeder.com)  
Web: [www.furbabyfeeder.com](http://www.furbabyfeeder.com)



Please scan this QR code to learn more about our products, thanks.

## Disclaimer

The Automatic Microchip Identify Pet Feeder is designed with selective access features to reduce the risk of pets eating each other's food. However, it is not possible to completely guarantee that no other pets will access the feeder under all circumstances. The manufacturer does not assume liability for any damage or inconvenience that may occur as a result.

## Note

THE MANUFACTURER IS NOT RESPONSIBLE FOR ANY RADIO OR TV INTERFERENCE CAUSED BY UNAUTHORIZED MODIFICATIONS TO THIS EQUIPMENT. SUCH MODIFICATIONS COULD VOID THE USER'S AUTHORITY TO OPERATE THE EQUIPMENT.



## User Manual

## Specifications

<b>Product Name</b>	Sphere Microchip Pet Feeder		
<b>Power</b>	Type-C 5V/1A power or 4pcs 1.5V CELL batteries		
<b>Product Size</b>	W255XD270XH227	<b>Input</b>	DC5V=1A
<b>Material</b>	ABS/Melamine/Silicone	<b>Capacity</b>	0.7L
<b>Cable length</b>	1.3m Type-C cable	<b>Power</b>	5W

## Accessories Details



## Welcome to Your New FurBabyFeeder Sphere Pet Feeder

- Introducing the FurBabyFeeder Sphere—where technology meets pet care. This smart automatic microchip pet feeder, equipped with a specialized RFID Collar Tag, precisely identifies your pet, granting exclusive access to their food. It's perfect for multi-pet homes, preventing food theft and reducing disease spread.
- Elevate your pet's dining experience with FurBabyFeeder's RFID technology. Simply attach the tag to your pet's collar, and they become the privileged members of an elite dining club. Unauthorized pets? Sorry, no entry.
- The Sphere model doesn't just feed your pet; it recognizes them thanks to its advanced infrared sensor, automatically opening the lid for a seamless, magical feeding experience.
- Trust FurBabyFeeder to keep your pet's food fresh and hygienic longer while deterring flying insects and reducing spoilage. The Sphere is not just a feeder, it's a guardian of your pet's health and happiness.

## Product Composition

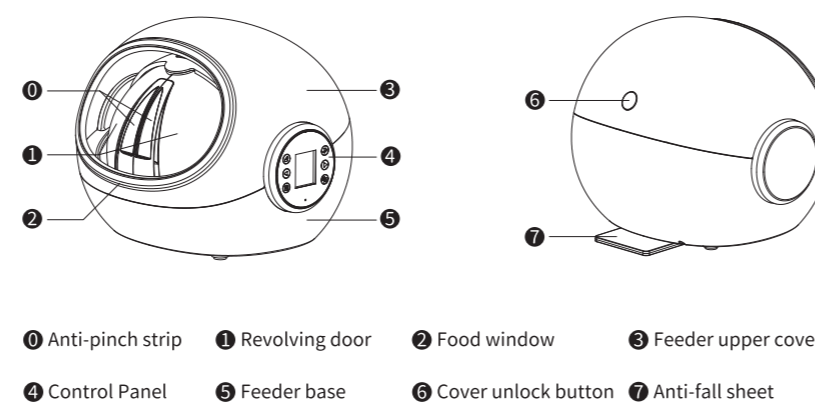

## Operating Instructions

### Connecting power

Open the anti-fall sheet, insert the power cord into the power socket at the bottom, snap the cord into the slot, and turn on the power switch. It is recommended to install 4 AA good quality 1.5V C cell batteries at the same time (batteries need to be purchased by yourself), which will automatically switch after a power outage, ensure the normal operation of the feeder.

Note: Battery power is limited and can last up to 48 hours, depending on use.

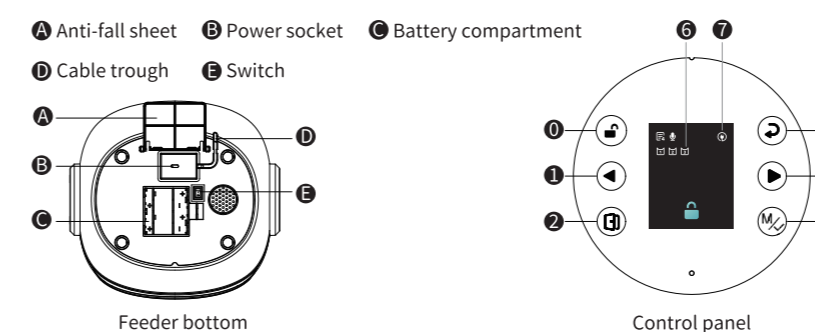

- Unlock/Lock button**  
Press and hold for 2 seconds to unlock, short press to lock
- Left key**  
Page left, digital adjustment decrease
- Open/Close door key**  
Press and hold for 1 second to open or close the door
- Return key**  
Return to the previous action or previous menu
- Right key**  
Page right, digital adjustment increase
- Menu/Confirm key**  
Click to enter the menu on the home page, and click to confirm in the menu
- Tag identification status**  
Shows read RFID tag
- Power supply**  
Shows the current power supply or battery supply mode

## Operating Instructions

### RFID Tag Adding

Click Menu > Adding ID > Choose the ID Number > Reading ID is successful > THEN CONFIRM THE ADDING > Hit Back Button 3 Times to go back to main menu.

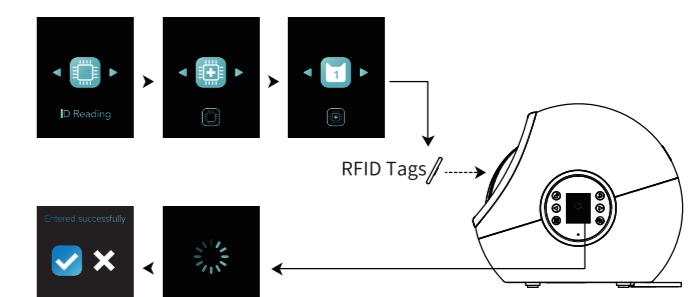

- Feeder support reading 3 tags.

### RFID Tag Deleting

Click menu>ID Reading>Delete ID>One key to delete all ID; Delete ID is successful, and THEN CONFIRM THE DELETING ✓.



- Deleting the ID does not require the RFID tag to be close the feeding window.